

CONTATTO™

design Gianfranco Marabese 2015
engineering Andrea Zandonà

Spotlight collection with variable light cones through a telescope movement, which is attached to the lamp by magnets to have free movement and adjustment of the light's effects

Materials: metal and aluminum

Finishes: matte white, matte black, brass

Light: LED 6.5W 650lm 3000°K

* ADD THE SPOTS TO THE MUTIPLE STRUCTURES: C1, C2, F1, C3, C6

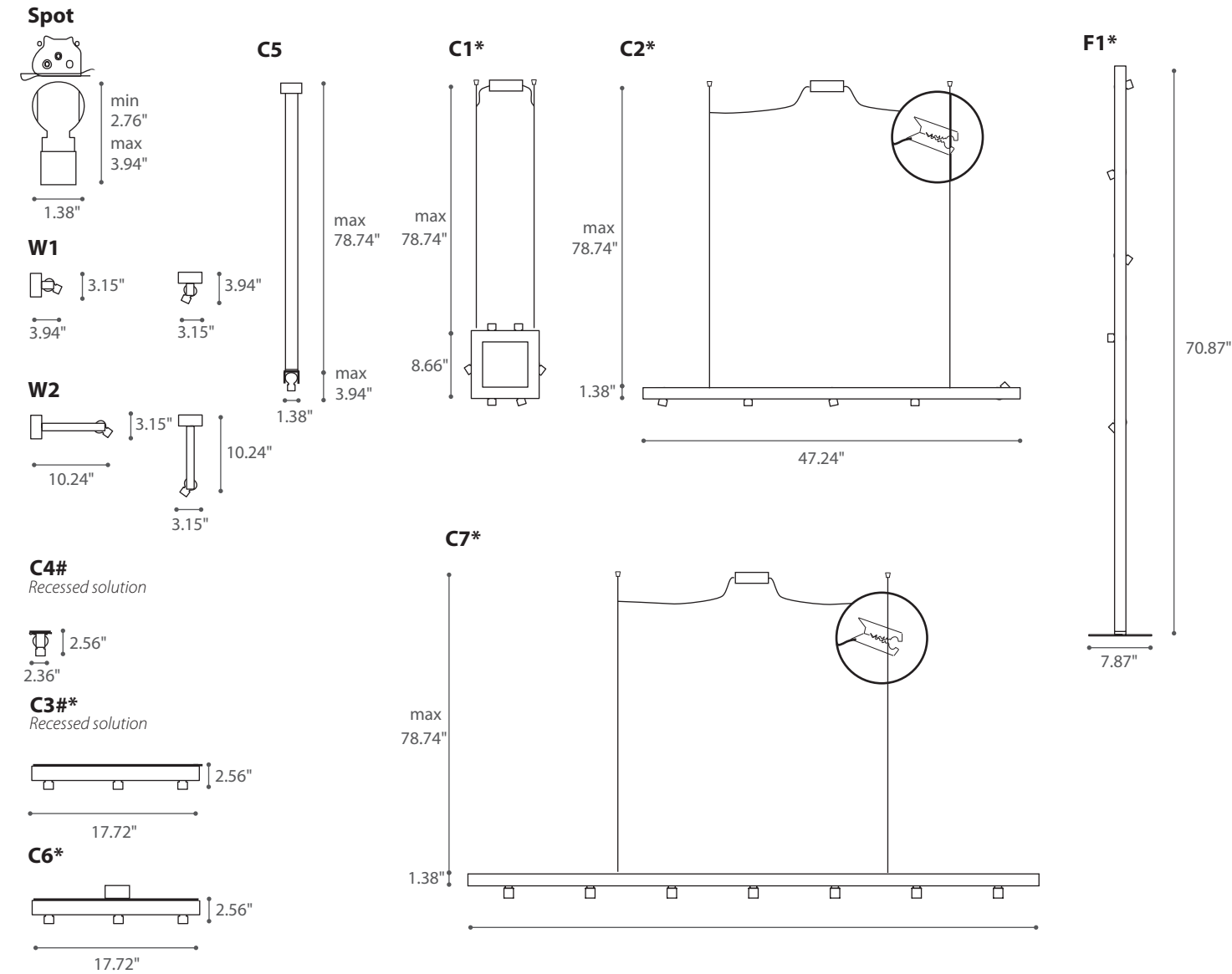

Spot	LED 6.5W 650lm 3000°K	min. 20° / max 40°
C7	only structure for max 7 spot, driver included	
C1	only structure for max 6 spot, driver included	
C2	only structure for max 5 spot, driver included	
C5	suspended single lamp's spot, driver included	
F1	only structure for max 5 spot, driver included	
C6	only structure for max 3 spot, driver included	
C3	only recessed structure for max 3 spot, driver not included	
W1	short wall lamp, spots and driver included	
W2	long wall lamp, spots and driver included	
C4	single recessed lamp, one spot included, driver not included	

66.14"

#C3/C4

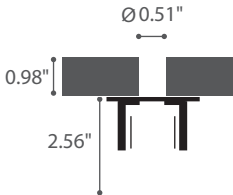

Recessed solution

SPECIFICATION SHEET

SCANGIFT

WWW.SCANGIFT.COM



