

PROJECT: _____ TYPE: _____

MODEL # _____ FINISH _____ WATT _____ LED COLOUR _____ HOUSING _____ POWER SUPPLY _____ VOLTAGE _____



SPECIFICATION SHEET

SCANGIFT®

WWW.SCANGIFT.COM

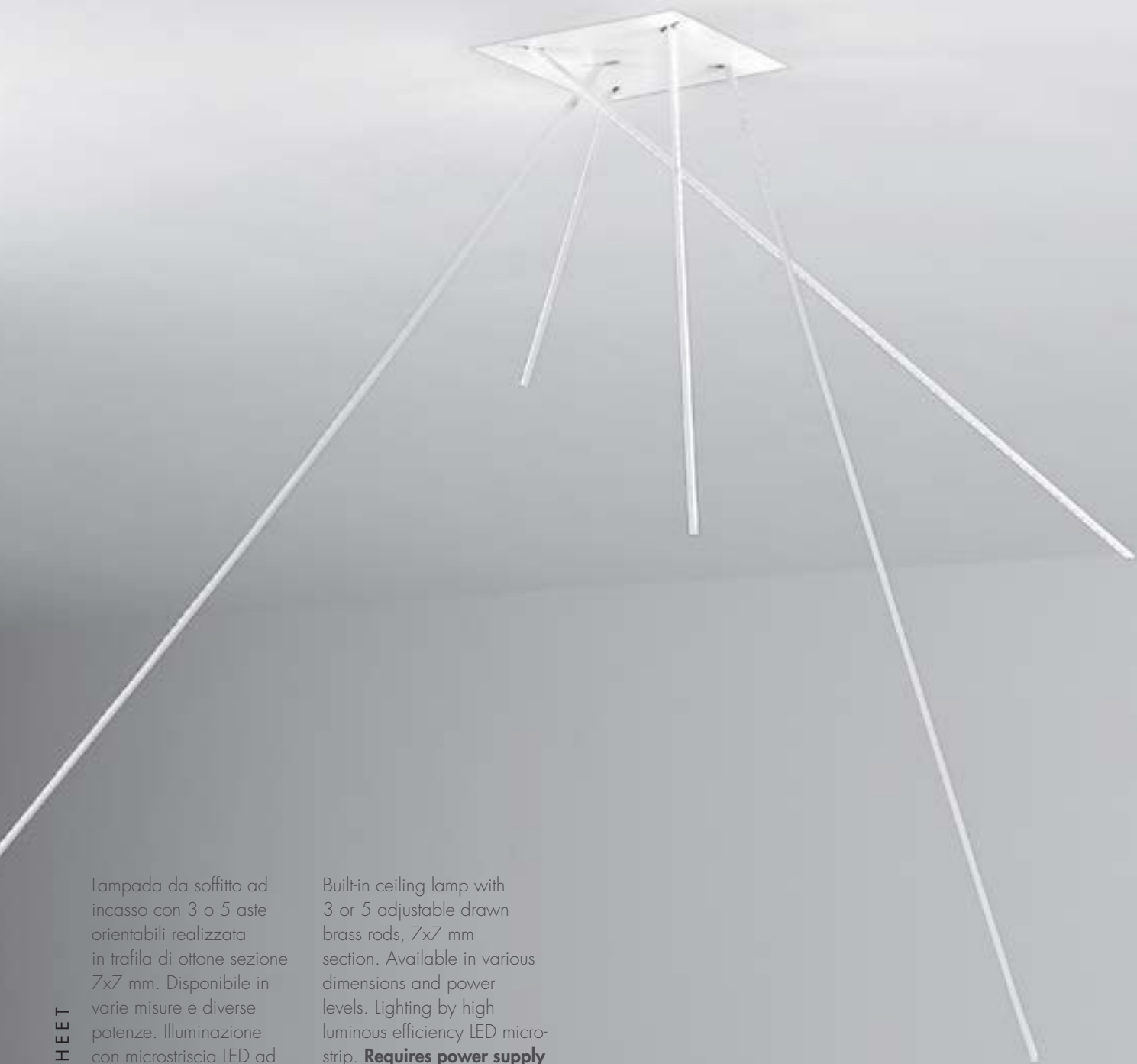

SPECIFICATION SHEET

Lampada da soffitto ad incasso con 3 o 5 aste orientabili realizzata in trafilata di ottone sezione 7x7 mm. Disponibile in varie misure e diverse potenze. Illuminazione con microstriscia LED ad alta efficienza luminosa.

Necessita di alimentatore e controcassa, non inclusi.*

Finiture colore:
verniciato bianco (BI),
verniciato nero (NE),
cromo (CR), oro (OR).

Mod. dep.

Alimentatori, controcasse e specifiche tecniche a pag. 20-21

Built-in ceiling lamp with 3 or 5 adjustable drawn brass rods, 7x7 mm section. Available in various dimensions and power levels. Lighting by high luminous efficiency LED micro-strip. **Requires power supply unit and wall housing, which is not included.***

Available in:
white varnish (BI), black varnish (NE), chrome (CR), gold (OR).

Registered design.

Power supply units, wall housings and technical specifications on page 20-21

* L'uso degli alimentatori codificati in tabella a pagina 20-21 (vedi specifiche tecniche) danno garanzia totale al prodotto. Using the power supply units listed on page 20-21 (see technical specifications) will result in full product warranty.

PROJECT: _____ TYPE: _____

MODEL # _____ FINISH _____ WATT _____ LED COLOUR _____ HOUSING _____ POWER SUPPLY _____ VOLTAGE _____



SPILLO3i

SPILLO5i

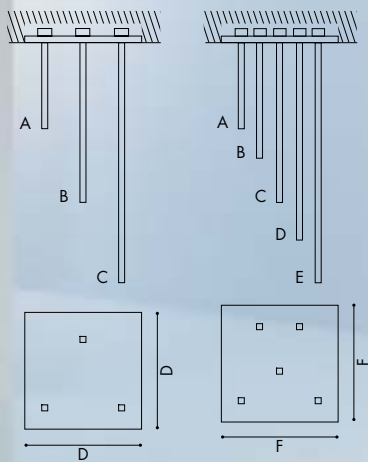

Art.	W	V	Lumen	°K led	A cm	B cm	C cm	D cm	E cm	F cm	∅7 cm
SPILLO3i.80	23,28	12	1980	3000	40	60	80	23			28x28
SPILLO3i.100	31,68	12	2640	3000	60	80	100	23			28x28
SPILLO5i	45,72	12	3850	3000	40	50	60	80	100	23	28x28

Classe energetica. Energy class.

Voltage options: 120V, 220V, 277V



SPECIFICATION SHEET

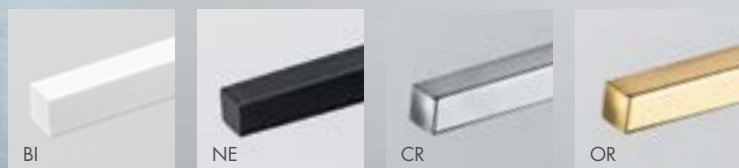

SPILLO™

design M. Pagnoncelli

SCANGIFT®

Lampada da parete e soffitto ad incasso con doppia asta orientabile realizzata in trafila di ottone sezione 7x7 mm. Disponibile in varie misure e diverse potenze. Illuminazione con microstriscia LED ad alta efficienza luminosa.

Necessita di alimentatore e controscassa, non inclusi.*

Finiture colore: verniciato bianco (BI), verniciato nero (NE), cromo (CR) e oro (OR).

Mod. dep.

Alimentatori, controscasse e specifiche tecniche a pag. 30-31

Built-in wall and ceiling lamp with double adjustable drawn brass rod, 7x7 mm section.

Available in various dimensions and power levels. Lighting by high luminous efficiency LED micro-strip.

Requires power supply unit and wall housing, which is not included.*

Available in: white varnish (BI), black varnish (NE), chrome (CR) and gold (OR).

Registered design.

Power supply units, wall housings and technical specifications on page 30-31



PROJECT:

TYPE:

MODEL #	FINISH	WATT	LED COLOUR	HOUSING	POWER SUPPLY	VOLTAGE
-	-	-	-	-	-	-

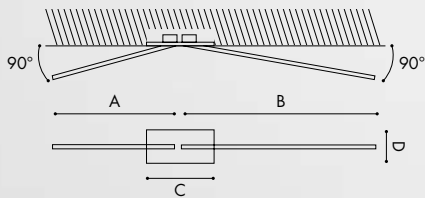

Art.	W	V	Lumen	°K led	A cm	B cm	C cm	D cm	Δ7 cm
SPILLO2iE.40	7,44	12	660	3000	20	40	15	5	10x20
SPILLO2iE.60	11,88	12	990	3000	30	60	15	5	10x20
SPILLO2iE.80	15,36	12	1320	3000	40	80	15	5	10x20
SPILLO2iE.100	19,80	12	1650	3000	50	100	15	5	10x20
SPILLO2iE.120	23,72	12	1980	3000	60	120	15	5	10x20

Classe energetica. Energy class.

Voltage options: 120V, 220V, 277V



* L'uso degli alimentatori codificati in tabella a pagina 30-31 (vedi specifiche tecniche) danno garanzia totale al prodotto. Using the power supply units listed on page 30-31 (see technical specifications) will result in full product warranty.

SPECIFICATION SHEET



SPECIFICATION SHEET

SCANGIFT®

WWW.SCANGIFT.COM



Lampada da parete e soffitto ad incasso a base tonda per applicazione a molla. Con asta orientabile realizzata in trafilata di ottone sezione 7x7 mm. Disponibile in varie misure e diverse potenze. Illuminazione con microstriscia LED ad alta efficienza luminosa.

Necessita di alimentatore non incluso.* Finiture colore: verniciato bianco (BI), verniciato nero (NE), cromo (CR), oro (OR).
Mod. dep.

Alimentatori e specifiche tecniche a pag. 30-31

Built-in wall and ceiling lamp with round, spring-mounted base. Featuring an adjustable drawn brass rod, 7x7 mm section. Available in various dimensions and power levels. Lighting by high luminous efficiency LED micro-strip. **Requires power supply unit, which is not included.***

Available in: white varnish (BI), black varnish (NE), chrome (CR), gold (OR).

Registered design.

Power supply units and technical specifications on page 30-31

Apparecchio adatto alla sostituzione di vecchi faretti da controsoffitto con foro incasso di circa 6 cm. A richiesta disponibile anche per fori di altri diametri.

This lamp is perfect for replacing spotlights in false ceilings with approx. 6 cm diameter recessed holes. Also available for different hole diameters on request.

* L'uso degli alimentatori codificati in tabella a pagina 30-31 (vedi specifiche tecniche) danno garanzia totale al prodotto. Using the power supply units listed on page 30-31 (see technical specifications) will result in full product warranty.

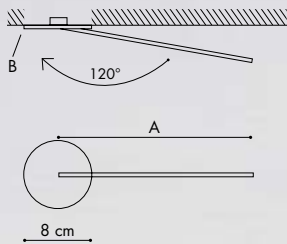

Art.	W	V	Lumen	°K led	A cm	B cm	φ cm
SPILLO 1iET.20	2,64	12	220	3000	20	0,2	6
SPILLO 1iET.30	3,96	12	330	3000	30	0,2	6
SPILLO 1iET.40	4,80	12	440	3000	40	0,2	6
SPILLO 1iET.50	6,60	12	550	3000	50	0,2	6
SPILLO 1iET.60	7,92	12	660	3000	60	0,2	6
SPILLO 1iET.80	10,56	12	880	3000	80	0,2	6
SPILLO 1iET.100	13,20	12	1100	3000	100	0,2	6
SPILLO 1iET.120	15,80	12	1320	3000	120	0,2	6

Classe energetica: Energy class. Voltage options: 120V, 220V, 277V



SPECIFICATION SHEET

Schema di montaggio controcasse per cartongesso / Assembly instructions for outer casing plasterboard



PROJECT:

TYPE:

MODEL #

FINISH

WATT

LED COLOUR

HOUSING

POWER SUPPLY

VOLTAGE

L'ESSENZIALITÀ COME MODO DI ESSERE

ESSENTIALITY AS A WAY OF LIFE

SPECIFICATION SHEET



SCANGIFT®

WWW.SCANGIFT.COM

SPILLO™

design M. Pagnoncelli

SCANGIFT®

Lampada da soffitto a 2, 3, o 5 aste orientabili realizzate in trafilata di ottone sezione 7x7 mm. Disponibile in varie altezze e diverse potenze. Illuminazione a microstrisce LED ad alta efficienza luminosa. Completa di alimentatore. Finiture colore: verniciato bianco (BI), verniciato nero (NE), bianco+cromo (BI+CR), foglia oro+oro (FO+OR).

Mod. dep.

Ceiling lamp with 2, 3 or 5 adjustable drawn brass rods, 7x7 mm section. Available in various dimensions and power levels. Lighting by high luminous efficiency LED micro-strip. Complete with power supply unit. Available in: white varnish (BI), black varnish (NE), white+chrome (BI+CR), gold leaf+gold (FO+OR).

Registered design.

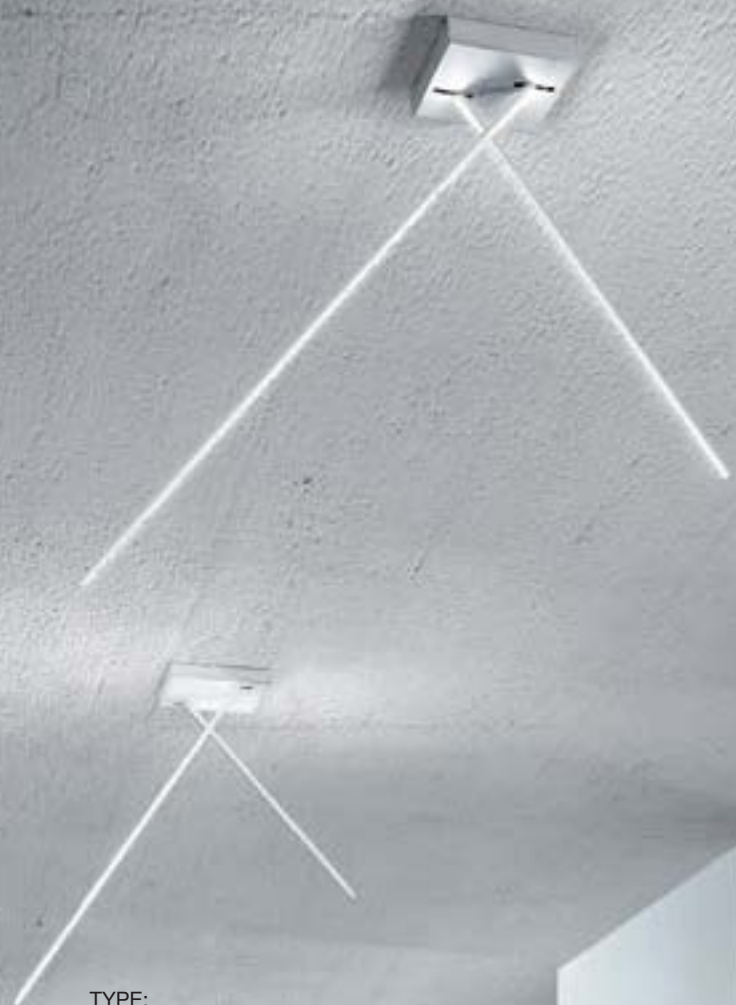

PROJECT:

TYPE:

MODEL # FINISH WATT LED COLOUR HOUSING POWER SUPPLY VOLTAGE

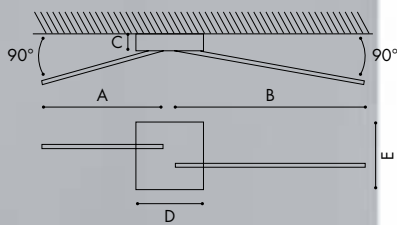

Art.	W	V	Lumen	°K led	A cm	B cm	C cm	D cm	E cm
SPILLO2.100	19,80	12	1650	3000	50	100	3	18	18
SPILLO2.120	23,76	12	1980	3000	60	120	3	18	18

Classe energetica. Energy class. Voltage options: 120V, 220V, 277V



SPECIFICATION SHEET





PROJECT:

TYPE:

MODEL # FINISH WATT LED COLOUR HOUSING POWER SUPPLY VOLTAGE

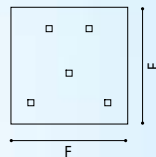
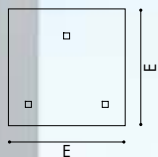
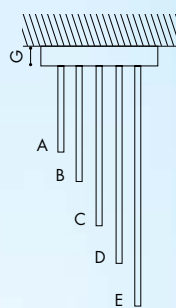
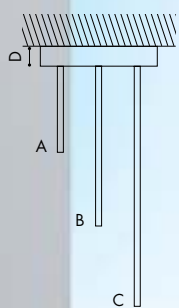

SPECIFICATION SHEET

Art.	W	V	Lumen	°K led	A cm	B cm	C cm	D cm	E cm	F cm	G cm
SPILLO3.80	23,28	12	1980	3000	40	60	80	3	25		
SPILLO3.100	31,68	12	2640	3000	60	80	100	3	25		
SPILLO5.120	45,72	12	3850	3000	40	50	60	80	100	25	3

Classe energetica. Energy class. Voltage options: 120V, 220V, 277V





ACCESSORI / ACCESSORIES

tabelle alimentatori - power supply data

	Art.	Output V	W	A mm	B mm	C mm		
	Alim.1	12	4,2	59	42	20		

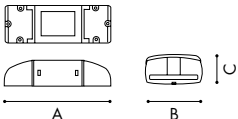
	Art.	Output V	W	A mm	B mm	C mm		
	Alim.2	12	8,4	70	42	20		

	Art.	Output V	W	A mm	B mm	C mm		
	Alim.3	12	16	138	40	28		

	Art.	Output V	W	A mm	B mm	C mm		
	Alim.4	12	25	117	75	20		

	Art.	Output V	W	A mm	B mm	C mm		
	Alim.5	12	48	206	51	36		

	Art.	Output V	W	A mm	B mm	C mm		
	Alim.EFUR.25dim	12	25	145	55	20		

	Art.	Output V	W	A mm	B mm	C mm		
	Alim.MB40	12	40	75	75	30		

	Art.	Output V	W	A mm	B mm	C mm		
	Alim.MDR45dim	12	45	206	51	36		

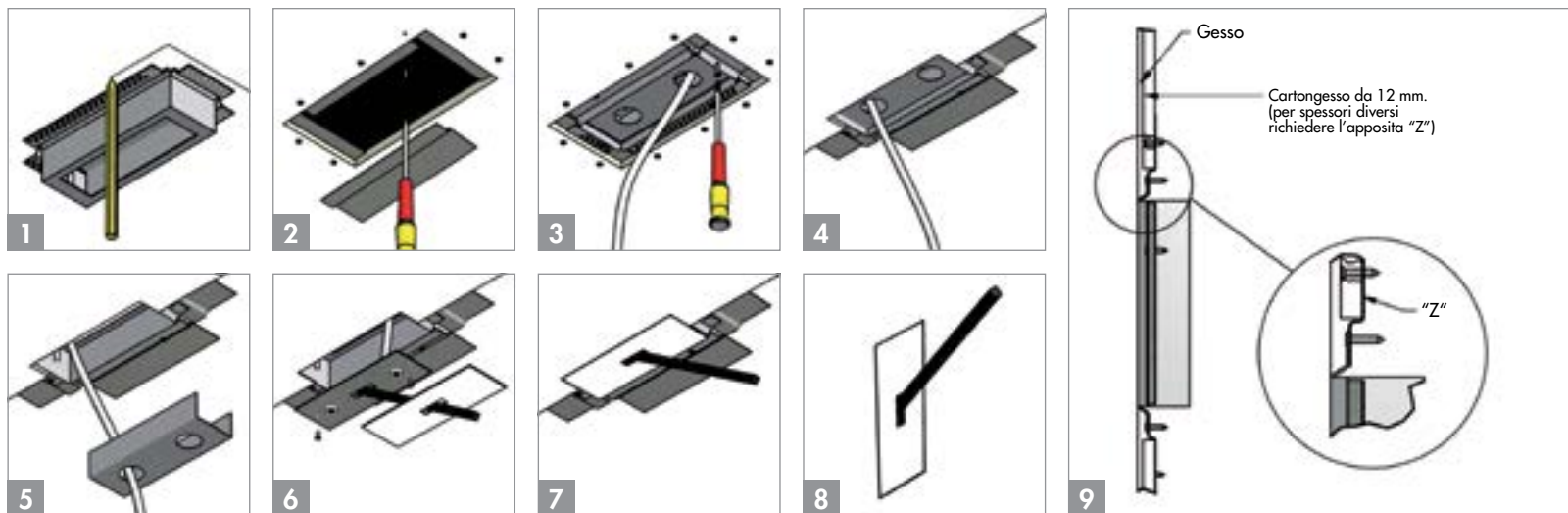

Codici controcasce cartongesso

	Cod.		Cod.
SPILLO1iE.20	CA.15	SPILLO2iE.40	CA.20
SPILLO1iE.30	CA.15	SPILLO2iE.60	CA.20
SPILLO1iE.40	CA.15	SPILLO2iE.80	CA.20
SPILLO1iE.50	CA.15	SPILLO2iE.100	CA.20
SPILLO1iE.60	CA.15	SPILLO2iE.120	CA.20
SPILLO1iE.80	CA.15		
SPILLO1iE.100	CA.15		
SPILLO1iE.120	CA.15		

Schema di montaggio controcasce per laterizio / Assembly instructions for outer casing masonry wall

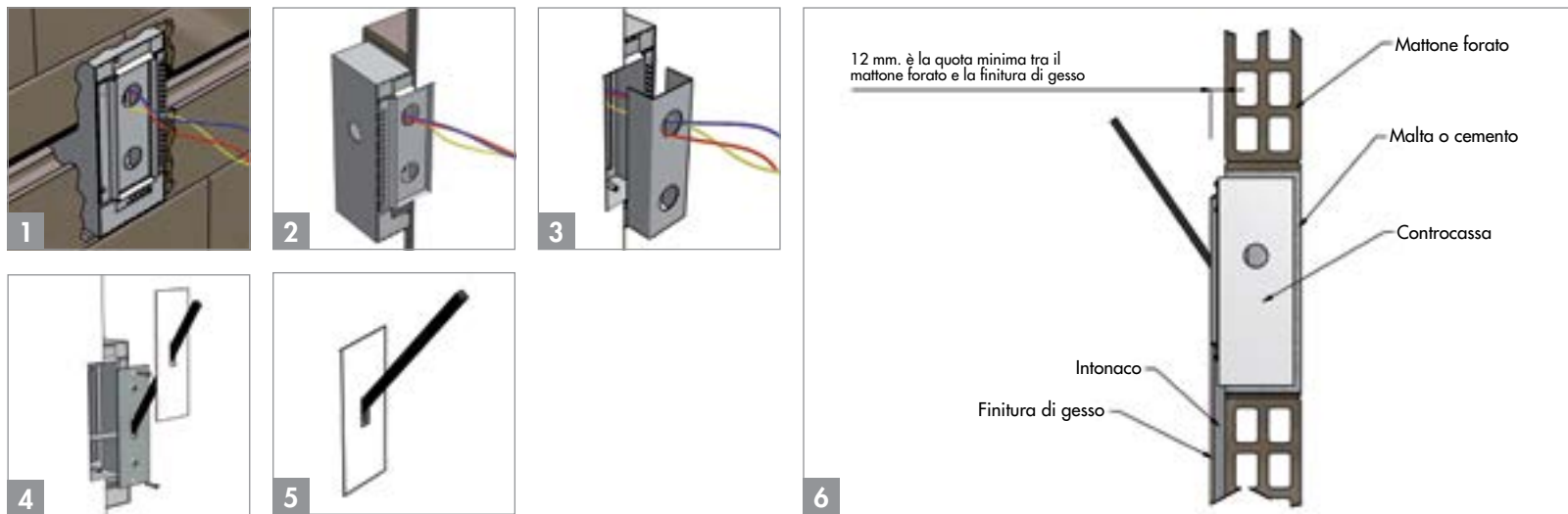

Codici controcasce laterizio

	Cod.		Cod.
SPILLO1iE.20	CA.15L	SPILLO2iE.40	CA.20L
SPILLO1iE.30	CA.15L	SPILLO2iE.60	CA.20L
SPILLO1iE.40	CA.15L	SPILLO2iE.80	CA.20L
SPILLO1iE.50	CA.15L	SPILLO2iE.100	CA.20L
SPILLO1iE.60	CA.15L	SPILLO2iE.120	CA.20L
SPILLO1iE.80	CA.15L		
SPILLO1iE.100	CA.15L		
SPILLO1iE.120	CA.15L		